

OUTDOOR BATTERY RECHARGEABLE WALL LAMP ROUND SIDERNO

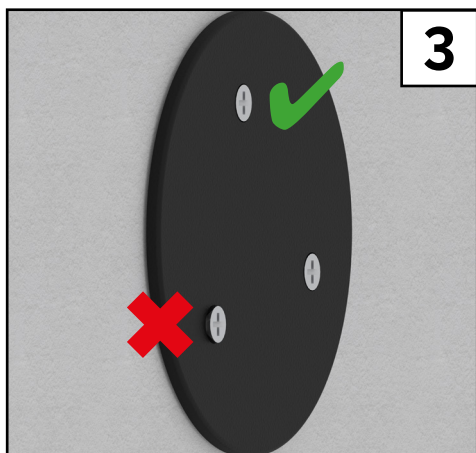

User Manual

DE	Benutzerhandbuch	LT	Vartotojo vadovas
BG	Ръководство за потребителя	LV	Lietotāja rokasgrāmata
CZ	Uživatelská příručka	NL	Gebruikershandleiding
DK	Brugervejledning	NO	Brukerhåndbok
EE	Kasutusjuhend	PL	Podręcznik użytkownika
ES	Manual del usuario	PT	Manual do utilizador
FI	Käyttäjän käsikirja	RO	Manual de utilizare
FR	Manuel d'utilisation	SE	Användarmanual
GR	Εγχειρίδιο χρήστη	SI	Uporabniški priročnik
HR	korisnički priručnik	SK	Používateľská príručka
HU	Felhasználói kézikönyv	TR	Kullanıcı Kılavuzu
IT	Manuale d'uso		

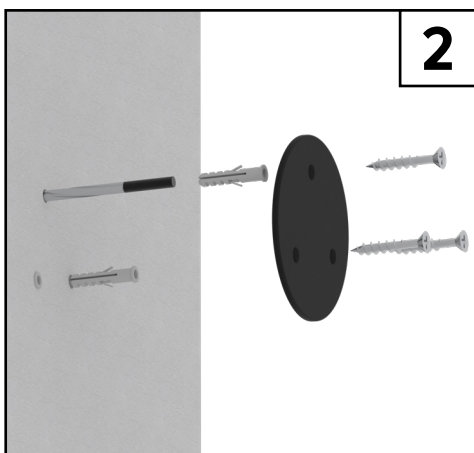
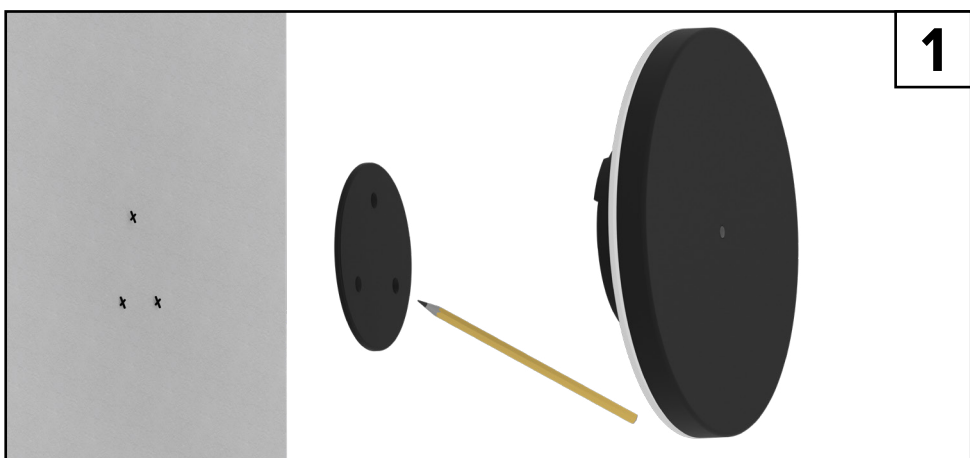
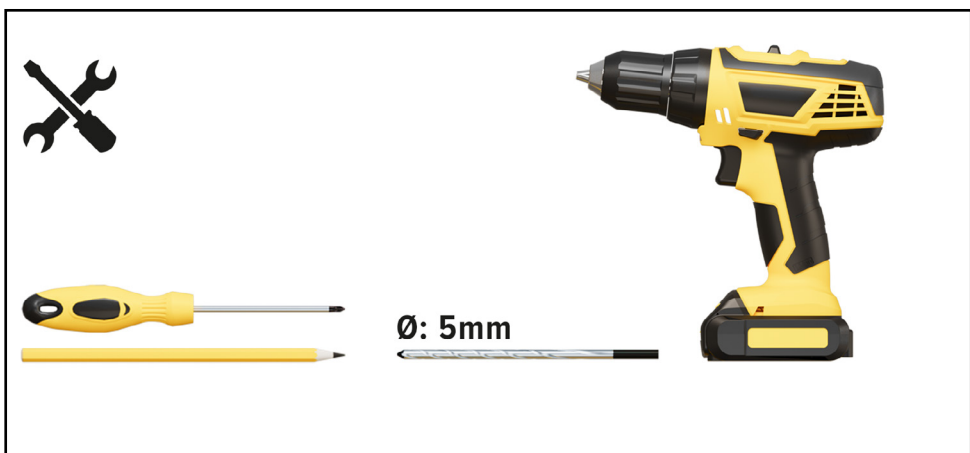
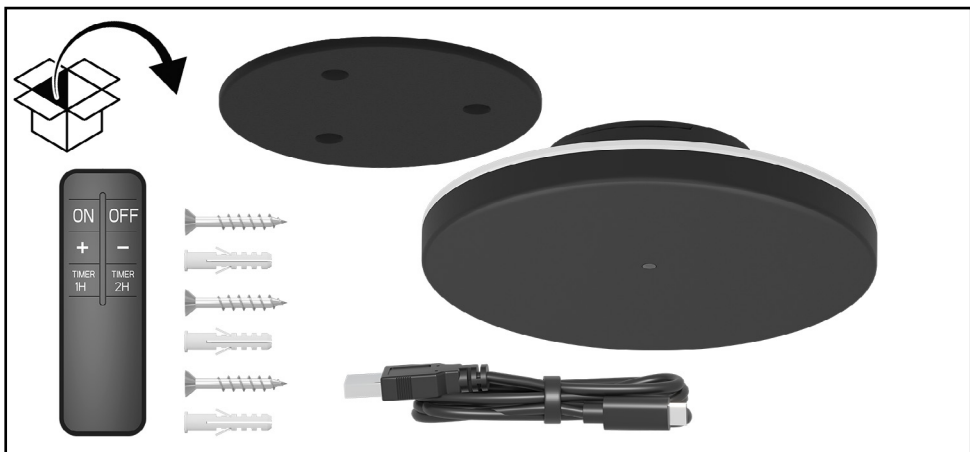

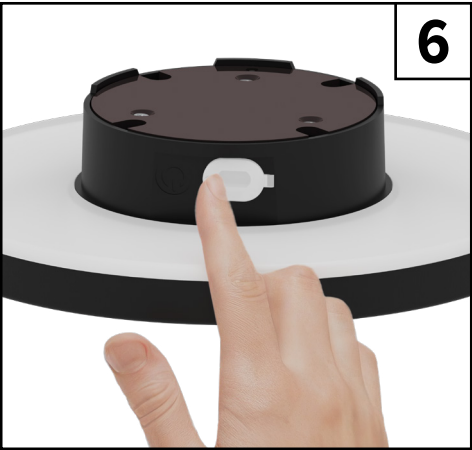
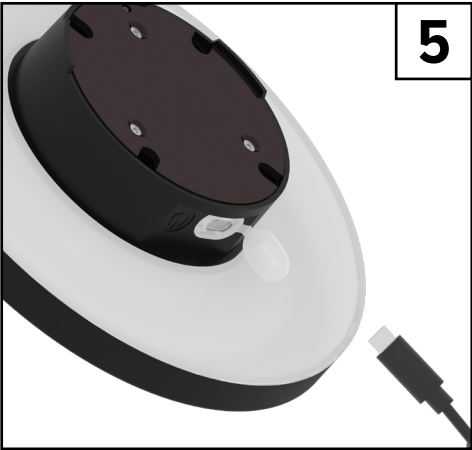
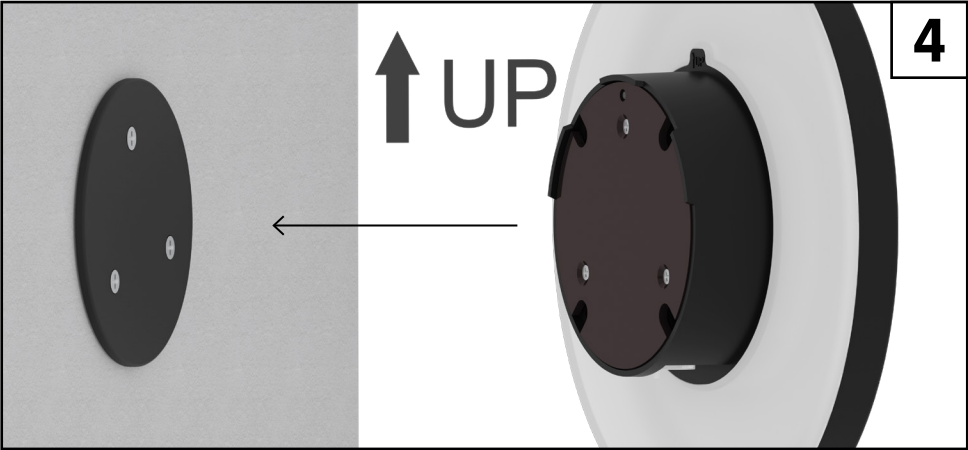

Safety



Conformity with all relevant requirements of the EU directive.

If applicable:

Use this device only for its intended purpose;

Do not use this device if it is damaged or defective.

Choose a location for the product where there is no risk of the cable being stepped on or tripped over. Do not place any objects on the cable.

If this product is damaged, especially if the cable or fitting is damaged, this product must be switched off immediately. In this case, replacement is required;

Before replacing it, turn off the power and let it cool down to avoid electric shock or burns.

The adapter (if applicable) must be installed near the unit, must not be connected to another adapter, and must be easily accessible.

Products should only be used with the original adapter.

This product should only be opened by a qualified technician if maintenance is required.

Never perform repairs yourself.

If this product is passed on to third parties, manuals must be included.



Choking hazard. Because packaging materials can be swallowed or misused, there is a risk of choking or injury. Keep packaging materials away from children.

Warranty

Any changes and/or modifications to the product will void the warranty. We cannot accept liability for damage caused by improper use of the product. Go to help.calex.eu for more information.

Disclaimer

Designs and specifications are subject to change without notice. All logos, brands and product references used are trademarks or registered trademarks of their respective holders and are hereby acknowledged as such.

Battery



This luminaire contains a built-in battery that is not replaceable.

Recycling

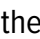

This product is labelled with this crossed out wheel bin symbol in accordance with European Directive 2012/19/EU to indicate that it must not be disposed of with your other household waste. Due to the presence of hazardous substances, mixtures or components, electrical and electronic devices that are not subject to selective sorting are potentially dangerous to the environment and human health. Please check your local city office or waste disposal service for the return and recycling of this product.

Explanation Safety Classes

-  Safety class I: Metal parts of equipment that fall into this class are connected to an earth protection conductor. If the product has a plug, it must be connected to an earthed socket; products that require installation are equipped with a ground terminal and must therefore be earthed; connect the ground wire (yellow green vein) to the -marked terminal.
-  Safety Class II: This product or any part of it is double insulated and does not need to be connected to a grounded outlet.
-  Safety Class III: Equipment in this group operates at an extra low voltage of less than 50 volts alternating current. For example, 24 volts.

The safety class is indicated on the product.

Explanation IP (Ingres Protection) Values

- IP20 Protected against solid objects greater than 12mm. No protection against liquids.
- IP44 Protected against solid objects greater than 1mm. Protection against vertical splashing water at an angle up to 60°.
- IP54 Prevents ingress of dust sufficient to cause harm. Protection against vertical splashing water at an angle up to 60°.
- IP65 Dust tight. No ingress of dust. Protected against powerful jets of water from all directions. Limited liquid entry.

Installation and operation

- 1. Determine the place where you want to install the Wall lamp. Mark the positions of the drill holes by using the mounting bracket as a template.
- 2. Drill the holes, place the plugs and screw the mounting bracket in place.
- 3. The screw heads should be parallel to the surface of the mounting bracket and should not protrude.
- 4. To attach the Wall lamp, simply click the lamp magnetically onto the mounting bracket. Make sure that the correct side (indicated by the arrow and the word UP) is positioned on top.
- 5. Before first use, the Wall lamp should be fully charged. Use a USB-C cable (included) and a 5Volt USB charger (not included) supplying at least 1.5Ampère. Allow 4-6 hours for initial charging time.
- 6. After the Wall lamp is fully charged, activate it on by double clicking the power-on button. This also activates the remote control. Once the Wall lamp is activated, you can turn it off and on by single clicking the power-on button. To adjust the brightness (10-100%), click and hold the power-on button until the desired brightness has been reached.
- 7. Test the Wall lamp and remote controller for proper operation. When pressing the 1 hour timer button on the remote, the Wall lamp will flash two times to confirm. When pressing the 2 hour timer button on the remote, the Wall lamp will flash four times to confirm.

Button operation

